

Plan de masse

01_APS_Plan de Masse

Echelle: 1:200 éme



TABLEAU DES SURFACES

- Surface terrain: 664 m²*
- Surface emprise bâtie: 120 m²*
- Surface plancher: 145,45 m²*
- Surface Parking: 26,60 m²*
- Surface pleine terre: 519,40 m²*

Rez de Chaussée

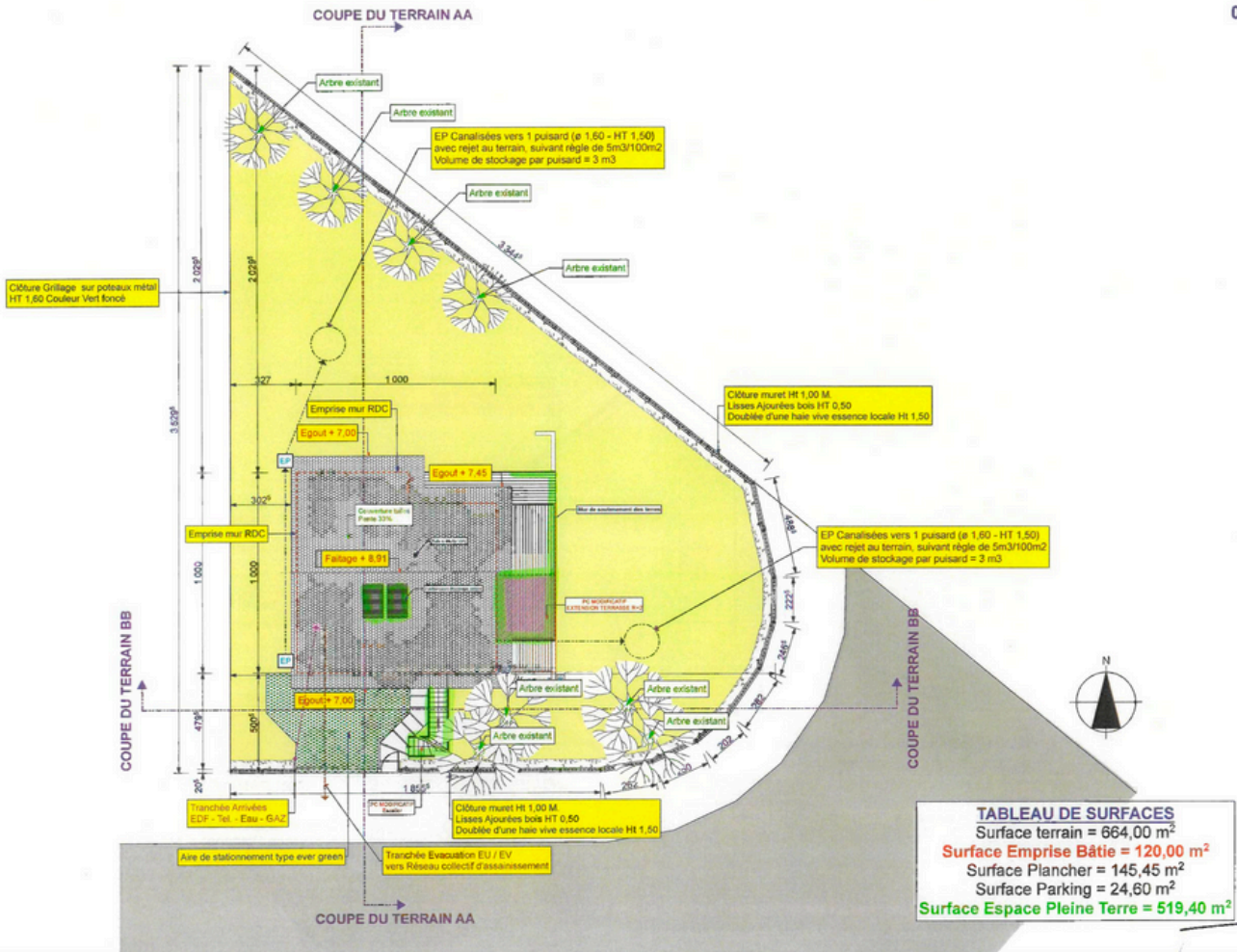
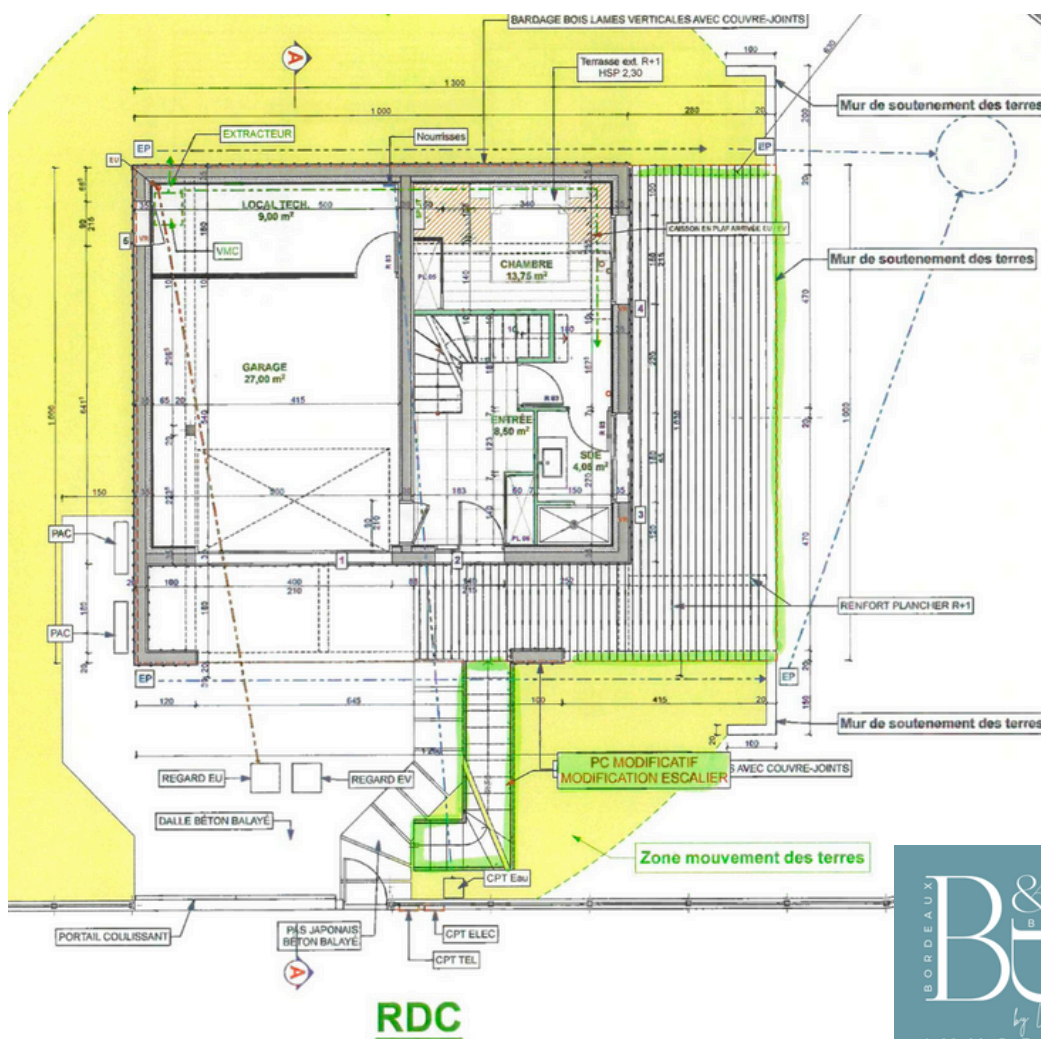

TABLEAU DES SURFACES

Entrée:	7 m ²
WC:	0,9 m ²
Chambre:	13,90 m ²
Salle d'eau:	4,05 m ²
<hr/>	
Total Habitable:	34,85 m ²
Local technique (buanderie):	9 m ²
Garage:	27 m ²
Total rez de chaussée:	61,85 m ²